

◆ Hexagonal Spacers - Brass

Material Specifications: Brass to Din 17660 CuZn39Pb3

Plating: Nickel to Din 267 G3E

Series IIMS - Tapped both ends

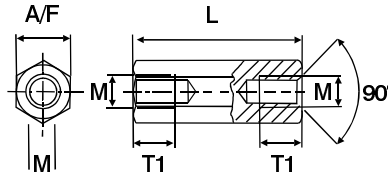

Tapped Depths - to Din 76-B			
Thread	A/f	T1	Tapped through up to L =
M2	4.0	6.0	11
M2.5	4.0	6.0	15
M2.5	5.0	6.0	17
M3	5.0 & 5.5	7.0	20
M4	7.0	9.0	25
M5	8.0	10.0	15
M6	10.0	15.0	15

BRASS • BRASS • BRASS • BRASS • BRASS • BRASS • BRASS • BRASS • BRASS • BRASS • BRASS • BRASS • BRASS • BRASS			
Thread	a/f	Order Code	Available Standard Lengths L ± 0.1 - Any custom length to order
M2	4.0	II-MS-2040-XX	05 06 07 08 09 10 11 12 13 14 15 16 17 18 19 20 21 22 23 24 25 26 27 28 29 30 35 40 45 50
M2.5	4.0	II-MS-2540-XX	05 06 07 08 09 10 11 12 13 13.5 14 15 16 17 18 19 20 21 22 23 24 25 26 27 28 29 30 33 35 38 40 45 50
M2.5	5.0	II-MS-2550-XX	05 06 07 08 09 10 11 12 13 13.5 14 15 16 17 18 19 20 21 22 23 24 25 30 35 40 45 50 55 60
M3	5.0	II-MS-3050-XX	05 06 07 08 09 10 11 12 13 13.5 14 15 16 17 18 19 20 21 22 23 24 25 26 27 28 29 30 31 32 33 34 35 36 37 38 39 40 43 45 50 55 60 65 70 75
M3	5.5	II-MS-3055-XX	05 06 07 08 09 10 11 12 13 14 15 18 20 21 22 23 24 25 26 27 28 29 30 31 32 33 34 36 36 37 38 39 40 45 50 55 60 65 70
M4	7.0	II-MS-4070-XX	05 06 07 08 09 10 11 12 13 13.5 14 15 16 17 18 19 20 21 22 23 24 25 26 27 28 29 30 33 35 38 40 45 50 55 60 65 70 75 80 85 90 95 100
M5	8.0	II-MS-5080-XX	05 08 10 12 15 18 20 25 30 35 40 45 50 55 60 65 70 75 80 85 90 95 100
M6	10.0	II-MS-6010-XX	05 08 10 12 15 18 20 25 30 35 40 45 50 55 60 65 70 75 80 85 90 95 100

Series IAMS - Threaded Stud / Tapped Hole

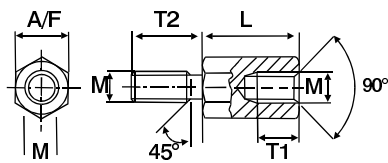

Tapped / Stud Depths - to Din 76-B			
Thread	A/f	T3	T2*
M2	4.0	6.0	5.0*
M2.5	4.0	6.0	6.0*
M2.5	5.0	6.0	6.0*
M3	5.0 & 5.5	7.0	6.0*
M4	7.0	9.0	8.0*
M5	8.0	10.0	8.0*
M6	10.0	10.0	10.0*

* Din standard length - for a custom stud add an 'A' suffix plus the length required to the order code:-
IA-MS-3050-20-A8 = Stud of 8mm

BRASS • BRASS • BRASS • BRASS • BRASS • BRASS • BRASS • BRASS • BRASS • BRASS • BRASS • BRASS • BRASS • BRASS			
Thread	a/f	Order Code	Available Standard Lengths L ± 0.1 - Any custom length to order
M2	4.0	IA-MS-2040-XX	05 06 07 08 09 10 11 12 13 14 15 16 17 18 19 20 21 22 23 24 25 26 27 28 29 30 35 40 45 50
M2.5	4.0	IA-MS-2540-XX	05 06 07 08 09 10 11 12 13 14 15 16 17 18 19 20 21 22 23 24 25 26 27 28 29 30 35 40 45 50
M2.5	5.0	IA-MS-2550-XX	05 06 07 08 09 10 11 12 13 13.5 14 15 16 17 18 19 20 21 22 23 24 25 26 27 28 29 30 35 40 45 50 55 60
M3	5.0	IA-MS-3050-XX	04 05 06 07 08 09 10 11 12 13 13.5 14 15 16 17 18 19 20 21 22 23 24 25 26 27 28 29 30 31 32 33 34 35 36 37 38 39 40 41 42 43 44 45 46 47 48 49 50 51 52 53 54 55 60
M3	5.5	IA-MS-3055-XX	05 06 07 08 09 10 11 12 13 13.5 14 15 16 17 18 19 20 21 22 23 24 25 26 27 28 29 30 31 32 33 33.5 34 35 36 37 38 39 40 41 42 43 44 45 46 47 48 49 50 55 60 65 70
M4	7.0	IA-MS-4070-XX	05 06 07 08 09 10 11 12 13 13.5 14 15 16 17 18 19 20 21 22 23 24 25 26 27 28 29 30 31 32 33 34 35 36 37 38 39 40 41 42 43 44 45 50 55 60 65 70 75 80 85 90 95 100
M5	8.0	IA-MS-5080-XX	05 08 10 12 15 18 20 25 30 35 40 45 50 55 60 65 70 75 80 85 90 95 100
M6	10.0	IA-MS-6010-XX	05 08 10 12 15 18 20 25 30 35 40 45 50 55 60 65 70 75 80 85 90 95 100